

FHB Series

Fuse Type Isolator Switch

YUEQING FEEO
ELECTRIC CO.,LTD

► Product Application

FHB series fuse type isolator is a product with advanced international level in the middle of the 90s. The rated voltage is 800V, rated voltage to 660V, rated current up to 630A, rated frequency 50Hz, power distribution and electric circuit high short-circuit current, used as power switch, isolation switch and emergency switch and circuit protection purposes, but generally not directly as a single motor for opening and closing.



► Technical Parameters

Convention heating current I _{th}	160A	250A	400A	630A
Rated insulation voltage U _i	800V/1500V			
Rated operating voltage U _e	AC400V, 690V/DC1000V			
Rated frequency	50Hz			
Rated connection capacity (A r.m.s)	10I _e			
Rated breaking capacity (A r.m.s)	8I _e			
Rated limit short-circuit current (r.m.s)	50KA			
Rated operating current	160A	250A	400A	630A
	100A	200A	315A	425A
Mechanical life (times)	5000	3000	2000	1500
Electric life (times)	1000	600	400	300
Weight (3P) kg	1.2	3.6	4.8	6.5
Auxiliary micro switch main parameters	50Hz, AC-15, 230V, 3A			

► Dimensions

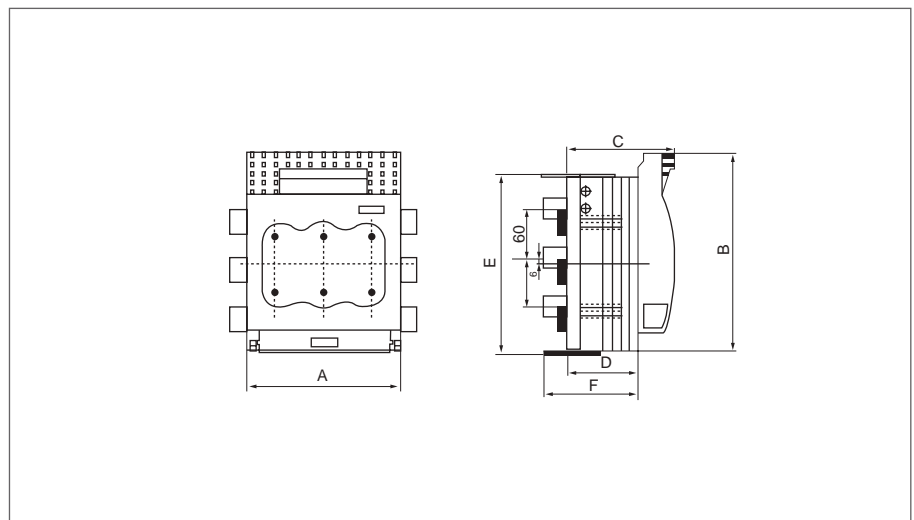

Model/Size	A	B	C	D	E	F
FHB-160/3	160	200	97	60	200	87
FHB-250/3	185	247	128	88	221	87
FHB-400/3	210	290	145	97	268	125
FHB-630/3	256	300	160	112	285	139