



**圆筒形帽熔断器**  
Cylindrical Cap Shape Fuse

### •用途

本系列熔断器适用于交流 50Hz, 额定电压至 690V, 额定电流至 125A。主要作为电气线路过载和短路保护 (gG/gL); 还可派生为半导体设备及其成套装置的短路保护 (aR) 以及电动机短路保护 (aM)。

本系列熔断器额定分断能力至 100KA。

本系列熔断器符合国家标准 GB13539.1-2008/IEC60269-1:2006, GB13539.2-2008/IEC60269-2:2006, GB13539.3-2008/IEC60269-3:2006 及国际电工委标准。

### •结构特点

由纯铜 / 银片 (或丝) 制成的变截面熔体封装于由高强度陶瓷或环氧玻璃布管制成的熔管内; 熔管中充满经化学处理过的高纯度石英砂作为灭弧介质。熔体二端采用点焊与端帽牢固连接。熔断体可带有撞击器, 当熔体熔断时, 撞击器立即动作, 推动微动开关, 发出各种信号或自动切换电路。根据用户需要, 还可生产特殊熔断体。

### •基本数据

熔断器型号、外形尺寸、额定电压、额定电流见图 / 表。

### •Application

This series fuse is suitable for AC 50Hz, rated voltage to 690V, rated current to 125A. It is mainly used for protecting the electrical circuit against overload and short-circuits (gG/gL); it also may derive for protecting the semiconductor device and others complete set installment from short-circuit (aR) as well as the electric motor from short-circuit (aM).

The rated breaking capability for this series fuse is to 100KA. IEC60269. This series fuse conforms to national standard GB13539.1-2008/IEC60269-1:2006, GB13539.2-2008/IEC60269-2:2006, GB13539.3-2008/IEC60269-3:2006 and international electrical committee standard .

### •Construction Feature

The variable cross-section fuse body made by pure copper/ silver piece (or silver wire) is sealed in the fusion tube which is made by the high strength porcelain or epoxy glass cloth pipe; there is full of the high-purity quartz sand processed after chemistry to take the extinguishing of arc medium in the tube. The two sides of the fuse use the spot welding to reliably connect with the end plate. The fuse may have striker, when the fuse element fusing the striker will act immediately to push the micro switch and send out each kind of signal or automatically transfer the circuit. According to requirement of user, it also may produce special fuse body.

### •Construction Feature

See the Figure /Table for the fuse model, overall dimensions, rated voltage and rated current.



有填料圆筒形帽系列熔断(器)体

A filler cap series of cylindrical fuse (for) body

序号 No.	型号 / 尺码 Model / Size	额定电压 (V) Rated Voltage	额定电流规格 (A) Rated current Specifications	外形尺寸 Overall dimension			
				ΦC	A	附图 Fig.	
0139	10.3 × 38T	380/500	2,4,6,8,10,12,16,20,25,32	10.3	38T	见图 Fig.1	
0140	5 × 20	250	0.5,1,2,4,6,10,12,13	5	20		
0141	5 × 25	250	0.5,1,2,4,6,10,12,16	5	25		
0142	6 × 20	250	0.5,1,2,4,6,10,12,16	6	20		
0143	6.3 × 23	250	0.5,1,2,4,6,10,12,16,20	6.3	23		
0144	6.3 × 25	250	0.5,1,2,4,6,10,12,16,20	6.3	25		
0145	6.3 × 31.5	250/500	0.5,1,2,4,6,10,12,16,20	6.3	31.5		
0146	8.5 × 23	250	0.5,1,2,4,6,10,12,16,20,25	8.5	23		
0147	8.5 × 31.5	250/500	0.5,1,2,4,6,10,12,16,20,25	8.5	31.5		
0148	8.5 × 36	380/500	2,4,6,8,10,12,16,20,25,32	8.5	36		
0149	10 × 30	380/500	2,4,6,8,10,12,16,20,25,32	10	30		
0150	10.3 × 28.5	250	2,4,6,8,10,12,16,20,25,32	10.3	28.5		
0151	10.3 × 31.5	250/500	2,4,6,8,10,12,16,20,25,32	10.3	31.5		
0152	10.3 × 34	250/500	2,4,6,8,10,12,16,20,25,32	10.3	34		
0153	10.3 × 38	380/500	2,4,6,8,10,12,16,20,25,32	10.3	38		
0154	10.3 × 57	690	2,4,6,8,10,12,16,20,25,32	10.3	57		
0155	14.3 × 38	250/500	2,4,6,8,10,12,16,20,25,32,40,50,63	14.3	38		见图 2 Fig.
0156	14.3 × 45	380/500	2,4,6,8,10,12,16,20,25,32,40,50,63	14.3	45		
0157	14.3 × 51	380/500	2,4,6,8,10,12,16,20,25,32,40,50,63	14.3	51		
0158	14.3 × 67	690	2,4,6,8,10,12,16,20,25,32,40,50	14.3	67		
0159	15 × 50	380/500	20,25,32,40,50	15	50		
0160	16.7 × 35	250/500	16,20,25,32,40,50,63	16.7	35		
0161	18 × 37	250/500	2,4,6,8,10,12,16,20,25,32,40,50,63	18	37		
0162	18 × 50	690	2,4,6,8,10,12,16,20,25,32,40,50,63	18	50		
0163	20.5 × 40	250/500	2,4,6,8,10,12,16,20,25,32,40,50,63	20.5	40		
0164	20.5 × 76	690	2,4,6,8,10,12,16,20,25,32,40,50,63	20.5	76		
0165	20.5 × 114	690	2,4,6,8,10,12,16,20,25,32,40,50,63	20.5	114		
0166	20.5 × 127	690	0.5,1,2,4,6,8,10,12,16,20,25,32	20.5	127		
0167	22.2 × 58	380/500	10,16,20,25,32,40,50,63,80,100,125	22.2	58		
0168	27 × 60	690	32,40,50,63,80	27	60		
0169	27 × 139	690	32,40,50,63	27	139		
0170	27 × 147	690	32,40,50,63	27	147		
0171	30 × 57	690	16,20,25,32,40,50,63,80,100,125	30	57	见图 3 Fig.	
0172	14.3 × 51H	380/500	2,4,6,8,10,12,16,20,25,32,40,50,63	14.3	51H		
0173	20.5 × 76H	690	2,4,6,8,10,12,16,20,25,32,40,50,63	20.5	76H		
0174	20.5 × 114H	690	2,4,6,8,10,12,16,20,25,32,40,50,63	20.5	114H		
0175	20.5 × 127H	690	0.5,1,2,4,6,8,10,12,16,20,25,32	20.5	127H		
0176	22.2 × 58H	690	10,16,20,25,32,40,50,63,80,100,125	22.2	58H		
0177	27 × 139H	690	32,40,50,63	27	139H		
0178	27 × 147H	690	32,40,50,63	27	147H		

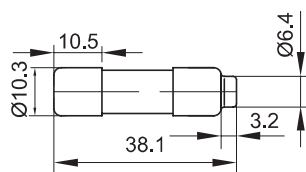

图(Fig.) 1

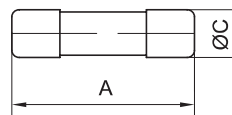

图(Fig.) 2

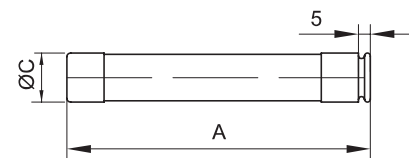

图(Fig.) 3

### ●特性曲线 Characteristic Curve

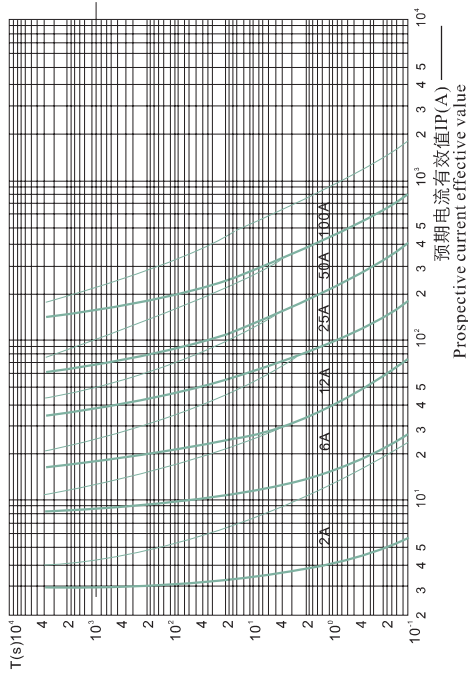

“gG” 熔断体的时间—电流带  
“gG” time-current of fuse body

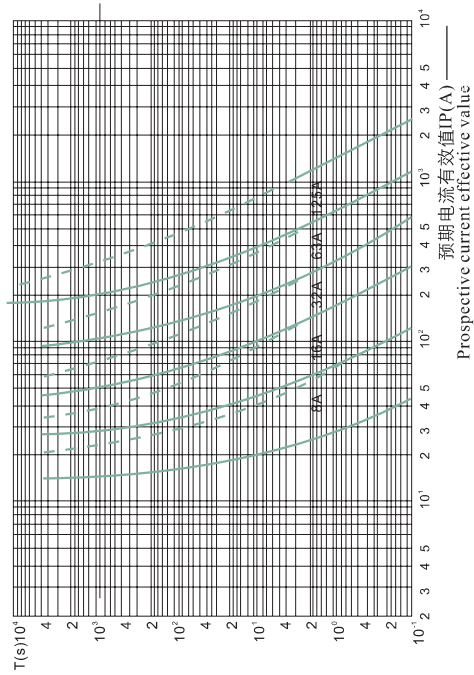

“gG” 熔断体的时间—电流带  
“gG” time-current of fuse body

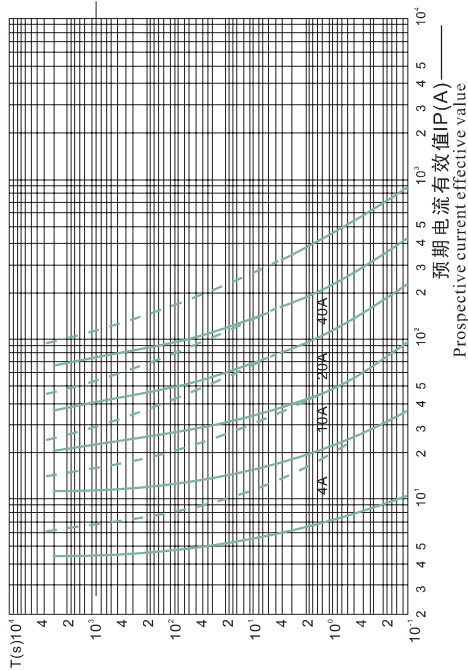

“gG” 熔断体的时间—电流带  
“gG” time-current of fuse body

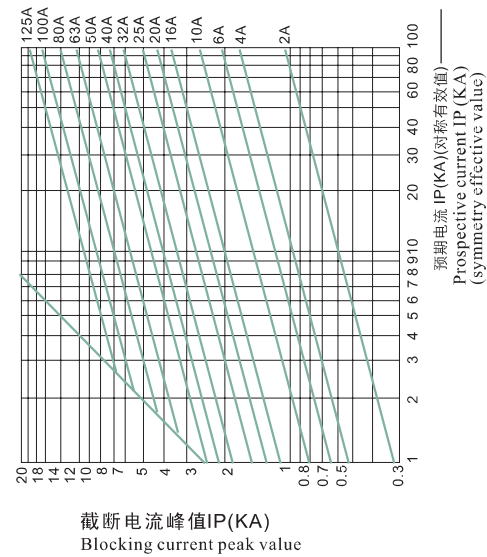

“gG” 熔断体的截断电流特性曲线  
“gG” blows a fuse the body the interruption electric current characteristic curve